

DISMANTLING JOINTS

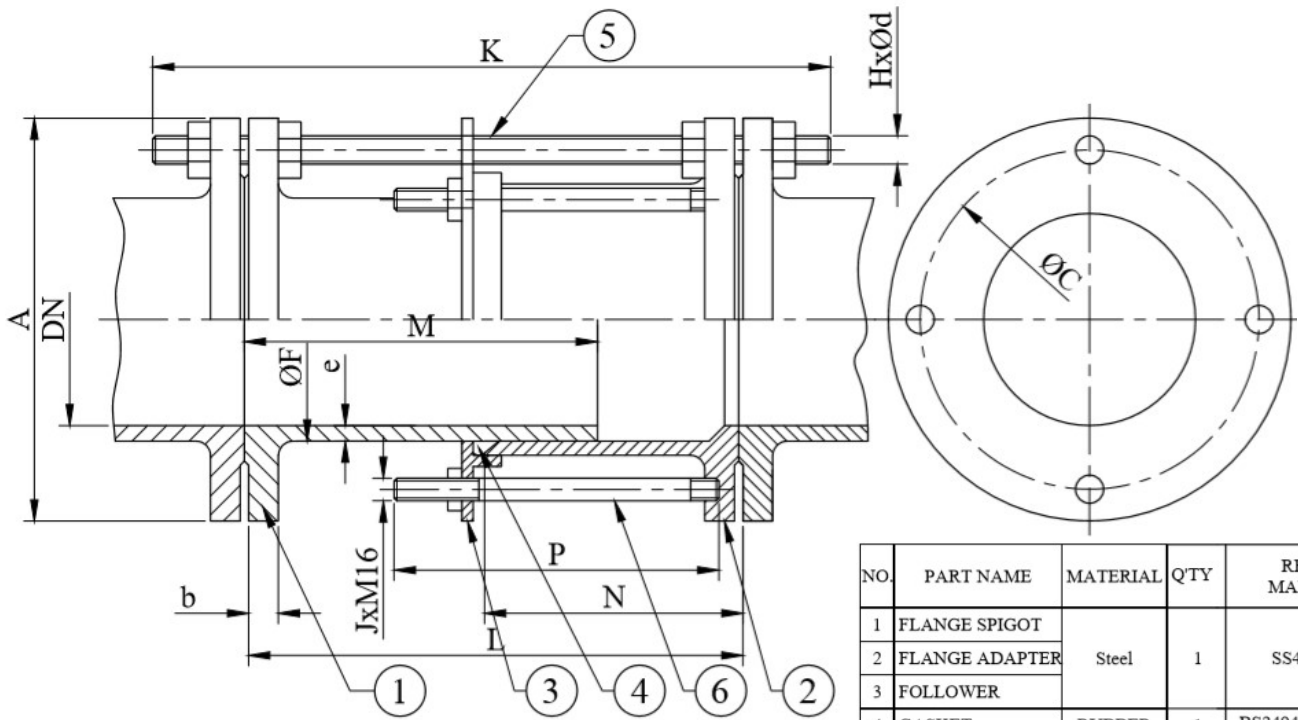

NO.	PART NAME	MATERIAL	QTY	RE-MARK
1	FLANGE SPIGOT	Steel	1	SS400
2	FLANGE ADAPTER			
3	FOLLOWER			
4	GASKET	RUBBER	1	BS2494(NBR)
5	TIE BOLT-NUT WASHER	(HOTDIP) STEEL	1 SET	TIS.171
6	STUD-NUT WASHER			

DN	A	b	c	e	F	H x Ød	J	K	L	M	N	P
80	200	19	160	8	98	4 x M20	4	560	350	250	180	230
100	220	19	180	8	118							
150	285	24	240	9.0	170							
200	340	26	295	9.8	222		6					
250	395		350	10.5	274							
300	445	400	11.2	326								
400	565	32	515	12.6	429	4 x M24	8	375	280	200	260	
500	670	38	620	14.0	352	10						
600	780	42	725	15.4	635	4 x M27	12	580	400			305
700	895	46	840	16.8	738							
800	1015	52	950	18.2	842	4 x M30	650	450	350			
900	1115	54	1050	18.2	914							
1000	1230	56	1160	21.0	1048	7 x M33	14	700	475	375		
1200	1445	62	1380	23.8	1255	8 x M36	16	780	525	425		
1400	1675	74	1590	26.6	1462	9 x M39	18	800	550	450		
1600	1915	92	1820	29.4	1668	10 x M45	20	840	575	475		



CHAIPONG ENGINEERING CO.,LTD.

Tel : 02-482-1526-7 Fax : 02-019-8911

email : chaipong_cpe@hotmail.com